

TDN1 RIGHT

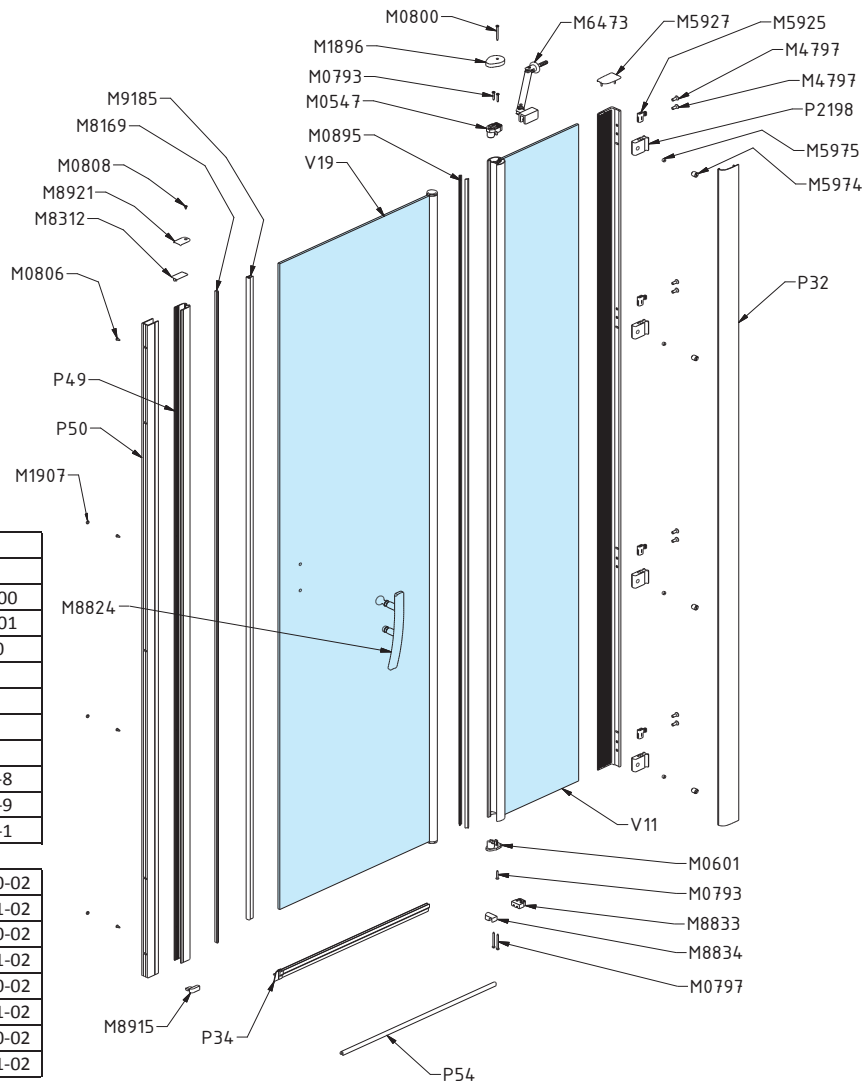

| | | | | |
|-----|------|----------|--|--------------|
| P32 | | brillant | | P2197 |
| | | elox | | P2205 |
| P33 | | brillant | | ND01-0973-00 |
| | | elox | | ND01-0973-01 |
| P34 | | | | ND01-2420 |
| P49 | | brillant | | P2698 |
| | | elox | | P2699 |
| P50 | | brillant | | P2700 |
| | | elox | | P2701 |
| P54 | 800 | | | ND01-2277-8 |
| | 900 | | | ND01-2277-9 |
| | 1000 | | | ND01-2277-1 |

| | | | | |
|-----|--------------|----------------------|--------------------|-----------------|
| V11 | 800;900;1000 | brillant+clear glass | brillant+ iré sklo | ND03-0198-00-02 |
| | | elox+clear glass | elox+ iré sklo | ND03-0198-01-02 |
| V19 | 800 | brillant+clear glass | brillant+ iré sklo | ND02-0517-00-02 |
| | | elox+clear glass | elox+ iré sklo | ND02-0517-01-02 |
| | 900 | brillant+clear glass | brillant+ iré sklo | ND02-0518-00-02 |
| | | elox+clear glass | elox+ iré sklo | ND02-0518-01-02 |
| | 1000 | brillant+clear glass | brillant+ iré sklo | ND02-0519-00-02 |
| | | elox+clear glass | elox+ iré sklo | ND02-0519-01-02 |